



# Blendeo+

---

## Blender

Designing Good Life

Svenska .....	sida	13
Dansk.....	side	14
Norsk .....	side	15
Suomi.....	sivu	16
English.....	page	17



- Läs häftet med säkerhetsinstruktioner och det här häftet noga innan du använder apparaten första gången.
- Læs hæftet med sikkerhedsanvisninger og dette hæfte omhyggeligt, inden apparatet tages i brug første gang.
- Les nøye heftet med sikkerhetsinstruksjoner og dette heftet før første gangs bruk.
- Lue turvallisuusohjekirjanen ja tämä kirjanen huolellisesti ennen ensimmäistä käyttökertaa.
- Read safety instructions and booklet carefully before using for the first time.

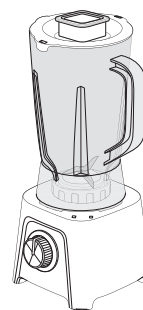

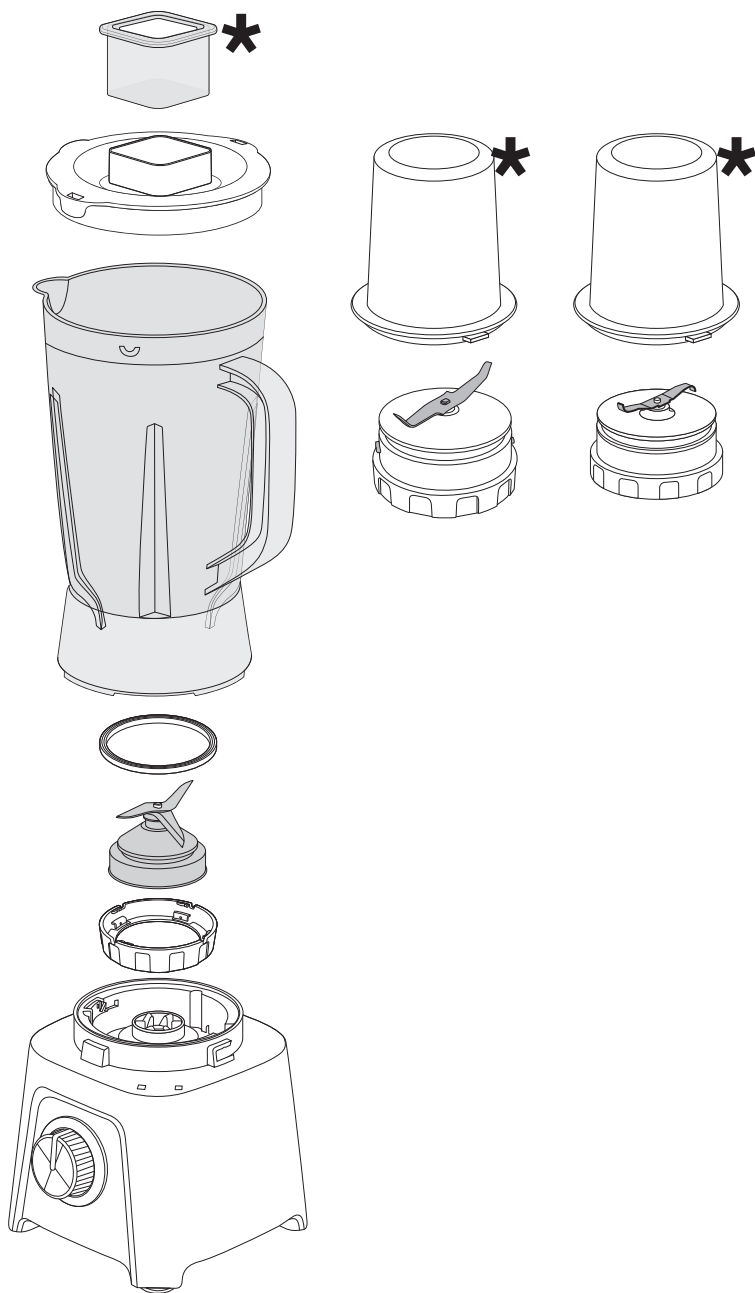

\* Depending on model

# 1

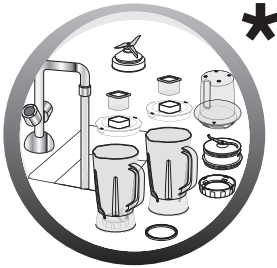

\*



## 2.1 \*

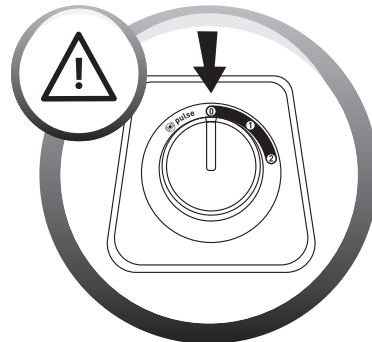
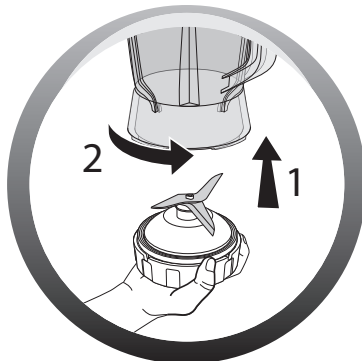
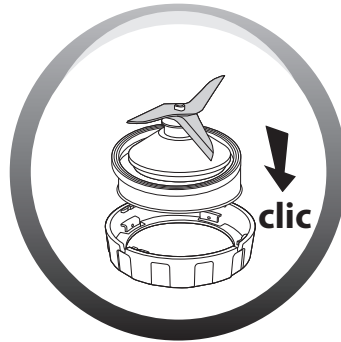
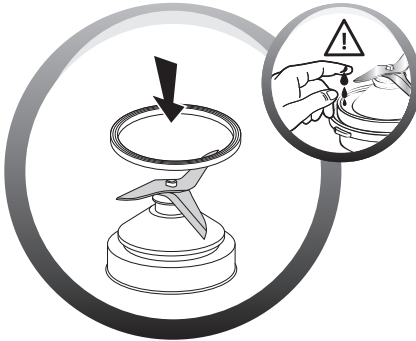

\* Depending on model

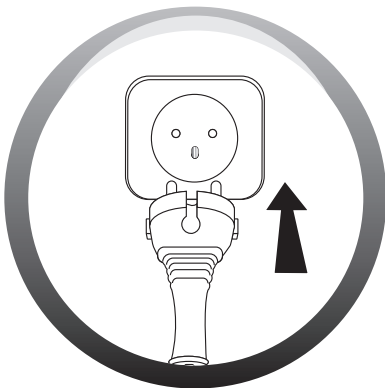
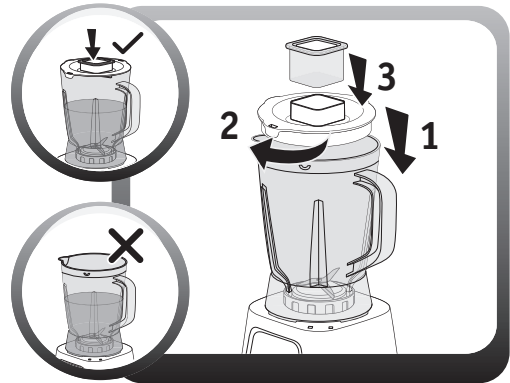
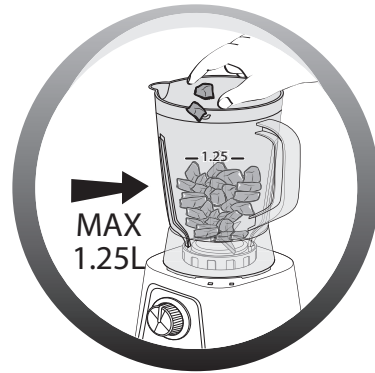
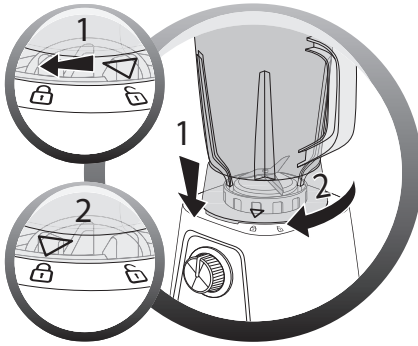

# 2.2



\*

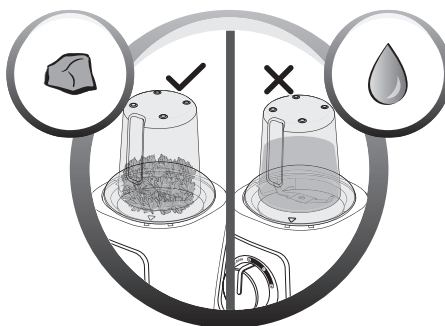
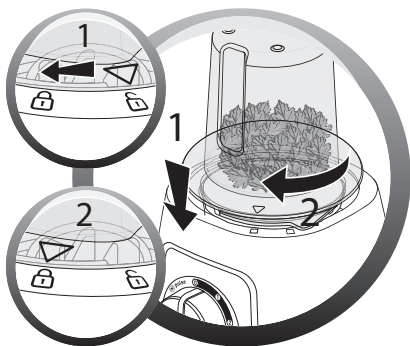
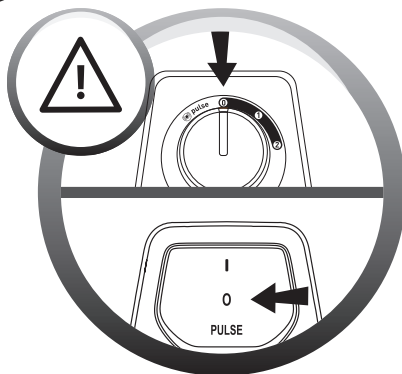
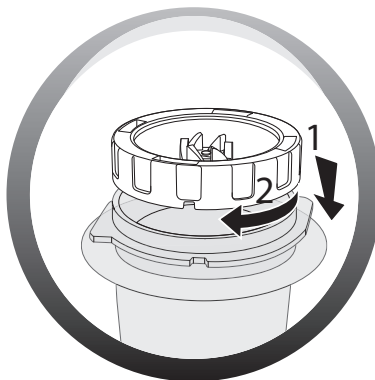



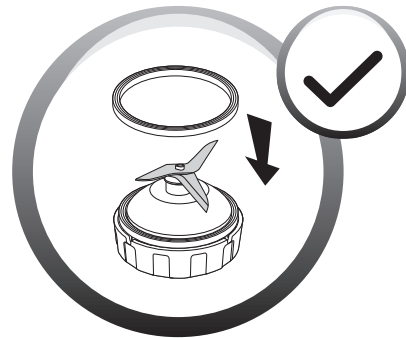
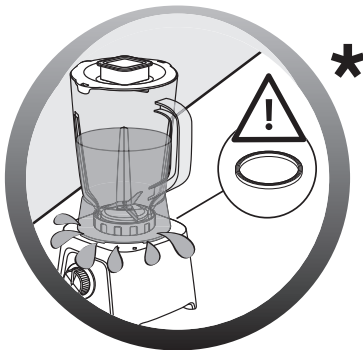
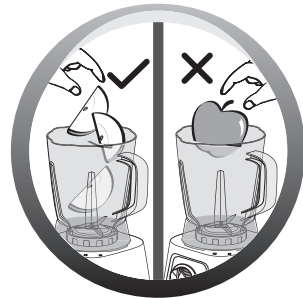
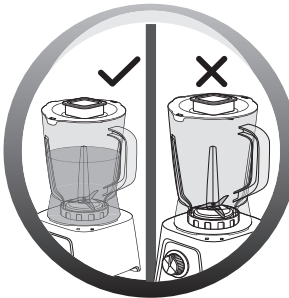
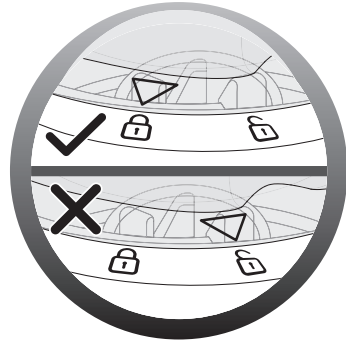
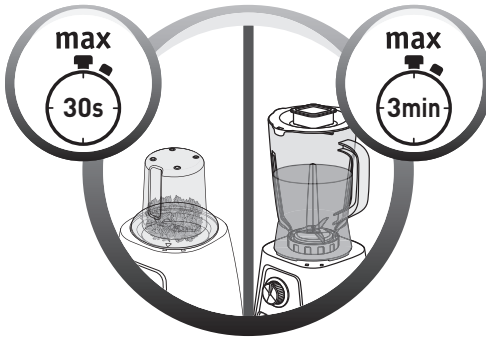

\* Depending on model





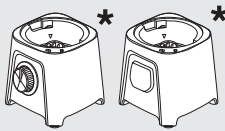
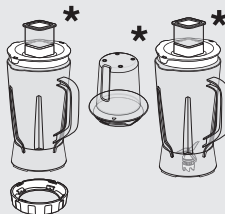



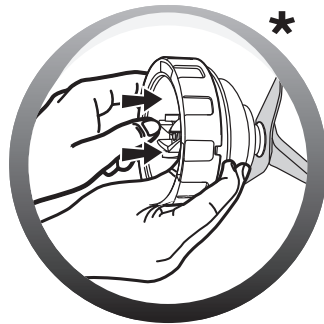





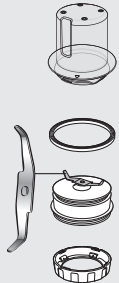

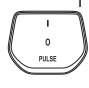

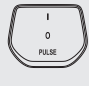

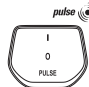



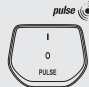



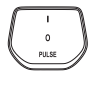

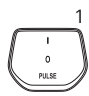

3

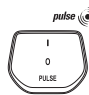
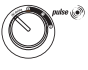

\* Depending on model

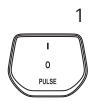
			
	✗	✗	✓
	✓	✓	✓
	✓	✗	✗



					
				5s	45g
				12s	100g
				<i>pulse</i>  x12	1 
				<i>pulse</i>  x8	60g
				<i>pulse</i>  x7	10g
				30s	40g
				<i>pulse</i>  x8	x8 (2cm x2cm x2cm) Max
				3min max	 500g
					 750ml

Om apparaten inte fungerar, kontrollera att den är ansluten till elnätet och att sladden är i gott skick. Vad gör jag ifall apparaten fortfarande inte fungerar? Vänd dig till ett auktoriserat servicecenter.

Hvis apparatet ikke virker, kontrolleres, at det nu også er tilsluttet netforsyningen. Virker apparatet stadig ikke? Kontakt et autoriseret servikværksted.

Dersom apparatet ikke virker, sjekk at det er koblet til strømnettet, og at ledningen er i god stand. Fungerer apparatet fortsatt ikke? Kontakt et godkjent serviceverksted.

Jos laite ei toimi, tarkasta, että siihen on kytketty virta oikein ja että johto on kunnossa. Eikö laitteesi vieläkään toimi? Ota yhteyttä valtuutettuun huoltopalveluun.

If your appliance does not work, check it is properly connected to the mains and the power cord is in good condition. Your appliance still does not work? Contact an approved service centre.



### **Var rädd om miljön!**

- ① Din apparat innehåller olika material som kan återanvändas eller återvinnas.
- ➔ Lämna den på en återvinningsstation eller på en auktoriserad serviceverkstad för omhändertagande och behandling.

Information om din garanti finns på [obhnordica.se](http://obhnordica.se)

### **TEFAL - OBH Nordica Group AB**

Löfströms Allé 5

172 66 Sundbyberg

Sweden

Phone: +46 8 629 25 00

[www.obhnordica.se](http://www.obhnordica.se)

### **Teknisk data**

OBH Nordica TYPE LH2C08N0

220-240V ~, 50-60 Hz

450 W



Rätt till löpande ändringar förbehålles.



### **Vi skal alle være med til at beskytte miljøet!**

- ① Apparatet indeholder mange materialer, der kan genvindes eller genbruges.
- ➔ Bring det til et specialiseret indsamlingssted for genbrug eller et autoriseret serviceværksted, når det ikke skal bruges mere.

Find information om din garanti på [obhnordica.dk](http://obhnordica.dk)

### **Groupe SEB Danmark A/S**

**Delta Park 37, 3. sal**  
**2665 Vallensbæk Strand**  
**Denmark**  
**Phone: +45 43 350 350**  
**[www.obhnordica.dk](http://www.obhnordica.dk)**

### **Tekniske data**

OBH Nordica TYPE LH2C08N0  
220-240V ~, 50-60 Hz  
450 W



Ret til løbende ændringer og forbedringer forbeholdes.



### Tenk miljøvern!

- ① Apparatet inneholder verdifullt materiale som kan gjenvinnes eller resirkuleres.
- ➡ Lever det ved et lokalt kommunalt gjenvinningsanlegg.

Finn informasjon om din garanti på [www.obhnordica.no](http://www.obhnordica.no)

**Groupe SEB Norway AS**  
**Philip Pedersens vei 20, 3 etg.**  
**1366 Lysaker**  
**Norway**  
**Phone: +47 22 96 39 30**  
**[www.obhnordica.no](http://www.obhnordica.no)**

### Tekniske data

OBH Nordica TYPE LH2C08N0  
220-240V ~, 50-60 Hz  
450 W



Retten til fortløpende endringer forbeholdes.



## Huolehtikaamme ympäristöstä!

- ① Laitteesi on varustettu monilla arvokkailla ja kierrätettävillä materiaaleilla.
- ➔ Toimita laitteesi keräyspisteeseen tai sellaisen puuttuessa vaikka valtuutettuun huoltokeskukseen, jotta laitteen osat varmasti kierrätetään.

Tuotettasi koskevat takuutiedot löydät osoitteesta **[www.obhnordica.fi](http://www.obhnordica.fi)**

**Groupe SEB Finland OY**  
**Bolero Business Park, Atomitie 2**  
**00370 Helsinki**  
**Finland**  
**Phone: +358 9 8946150**  
**[www.obhnordica.fi](http://www.obhnordica.fi)**

## Tekniset tiedot

OBH Nordica TYPE LH2C08N0  
220-240V ~, 50-60 Hz  
450 W



Oikeus muutoksiin pidätetään.



### **Environment protection first!**

- ① Your appliance contains valuable materials which can be recovered or recycled.
- ➔ Leave it at a local civic waste collection point.

Information about your warranty is available at [www.obhnordica.com](http://www.obhnordica.com)

### **TEFAL - OBH Nordica Group AB**

Löfströms Allé 5

172 66 Sundbyberg

Sweden

Phone: +46 8 629 25 00

[www.obhnordica.com](http://www.obhnordica.com)

### **Technical data**

OBH Nordica TYPE LH2C08N0

220-240V ~, 50-60 Hz

450 W



These instructions are subject to alterations or improvements.



Scan the QR code  
to receive our latest offers.

Designing Good Life

SE / KK / LH2C08N0 / 200225  
REF: 8020012214/01